

P E R M I T

CITY OF NAPOLEON
255 W. RIVERVIEW AVE
NAPOLEON, OHIO 43545

DIVISION OF BUILDING & ZONING
PH (419) 592-4010
FAX (419) 599-8393

PERMIT NO: 812 DATE ISSUED: 10-02-01 ISSUED BY: SKE

JOB LOCATION: 911 W GRACEWAY DR EST. COST:

LOT #: SUBDIVISION NAME:

OWNER: POTH, BERT
ADDRESS: 911 W GRACEWAY DR
CSZ: NAPOLEON, OH 43545
PHONE: 419-592-6170

AGENT: JERRY GLANZ TRENCHIN
ADDRESS: 6 LAKEVIEW DR
CSZ: NAPOLEON, OH 43545
PHONE: 419-599-4103

USE TYPE - RESIDENTIAL: OTHER:

ZONING INFORMATION

DIST: LOT DIM: AREA: FYRD: SYRD: RYRD:
MAX HT: # PKG SPACES: # LOADING SP: MAX LOT COV:

BOARD OF ZONING APPEALS:

WORK TYPE - NEW: REPLMNT: X ADD'N: ALTER: REMODEL:

WORK INFORMATION

SIZE - LGTH: WIDTH: STORIES: LIVING AREA SF:
GARAGE AREA SF: HEIGHT: BLDG VOL DEMO PERMIT:

WORK DESCRIPTION
SANITARY SERV REPL

FEE DESCRIPTION	PAID DATE	FEE AMOUNT DUE
SEWER INSPECTION PER		25.00

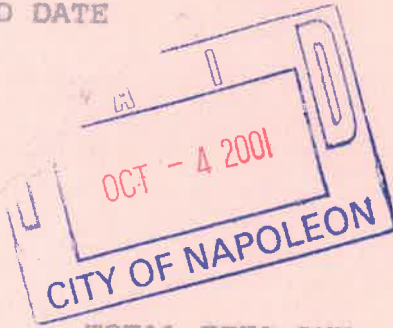

TOTAL FEES DUE 25.00

DATE

APPLICANT SIGNATURE

CITY OF NAPOLEON INSPECTION FORM

PERMIT #: 812

DATE ISSUED: 10-02-2001

JOB LOCATION: 911 W GRACEWAY DR

OWNER: POTH, BERT

OWNER PHONE: 419-592-6170

CONTRACTOR: JERRY GLANZ TRENCHING

CONTRACTOR PHONE: 419-599-4103

WORK DESCRIPTION: SANITARY SERV REPL

PLUMBING: UNDGR _____ RGHIN _____ FINAL _____

SEWER INSP 10-2-01

MECHANICAL: UNDGR _____ RGHIN _____ FINAL _____

FURNACE REPLC _____ AIR COND _____

ELECTRICAL: UNDGR _____ RGHIN _____ FINAL _____

SERV UPGR _____

BUILDING: SITE _____ FTG _____ FNDT _____

STRUC _____ ROOF _____ EXT _____

VENT _____ ACCES _____ EGRS _____

SMKDT _____ FINAL _____

ISSUE TEMP OCCUP _____ ISSUE OCCUP _____

STRG SHED: SITE _____ FINAL _____

SIGN: FTG _____ FINAL _____

FENCE: SITE _____ FINAL _____

MISC INSP: _____

NOTES: _____

INSPECTOR INITIALS: BMR

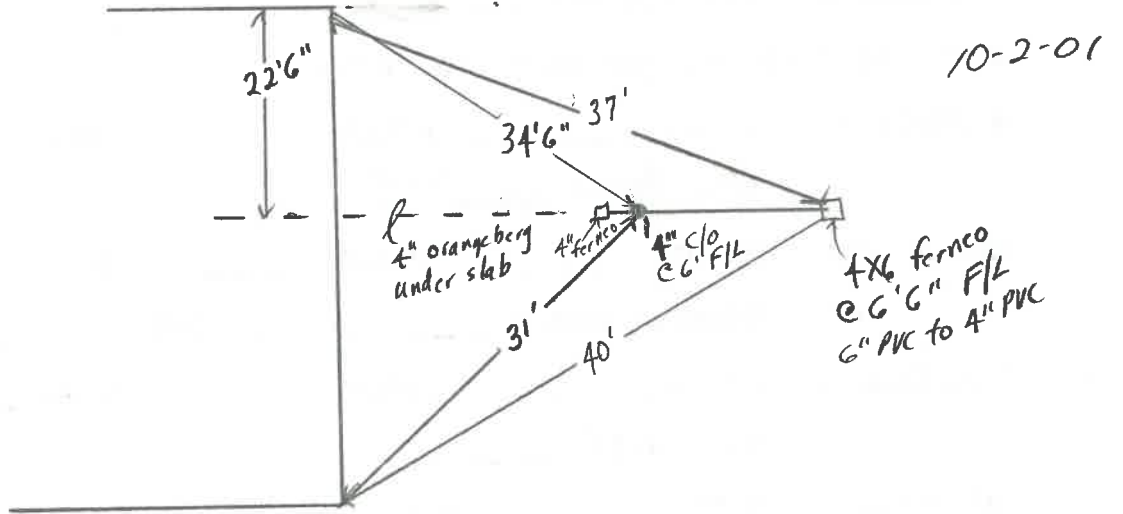

Orangeberg collapsing under slab
suggested the replace ASAP.

Brent

Jerry Colanz
7-17-02

911 W. Grassway

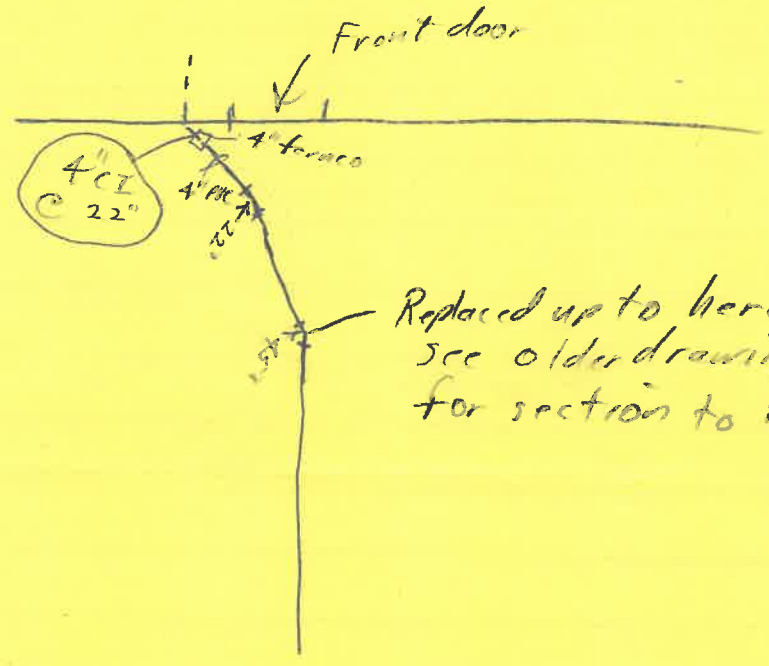

Replaced up to here
see older drawing in file
for section to top of curb.

~~Need permit.~~
~~S. Perry Dr. measuring store~~

